



**Woodlands End Woodland Avenue, Windsor, SL4 4AG**  
**£835,000**



## Woodlands End Woodland Avenue, Windsor, SL4 4AG

Nestled in the esteemed Woodland Avenue of Windsor, this impressive three-bedroom bungalow offers a perfect blend of comfort and convenience. The property is ideally located near local amenities, reputable schools, and excellent transport links, making it a desirable choice for families and professionals alike.

This bungalow is a rare find, combining spacious living with a prime location, making it an ideal choice for those seeking a peaceful yet connected lifestyle in Windsor.

Why not call today on 01753 621234 to arrange a viewing



**Property Summary**

Nestled in the esteemed Woodland Avenue of Windsor, this impressive three-bedroom bungalow offers a perfect blend of comfort and convenience. The property is ideally located near local amenities, reputable schools, and excellent transport links, making it a desirable choice for families and professionals alike.

Upon entering, you are welcomed into a spacious living and dining room, which is bathed in natural light thanks to the elegant French doors that open out to the garden. This seamless connection to the outdoors enhances the living space, perfect for entertaining or enjoying quiet moments in the fresh air. The well-fitted kitchen boasts integral appliances and leads to a practical utility room, complemented by a convenient washroom.

The bungalow features three generously sized bedrooms, with the main bedroom being particularly spacious. It benefits from built-in storage along one wall and an ensuite shower room, providing a private retreat. The two additional bedrooms also come with built-in storage, ensuring ample space for personal belongings. A family bathroom serves the home, offering both functionality and comfort.

Outside, the property is equally impressive. A double garage and workshop are conveniently located adjacent to the house, providing excellent storage and workspace options. The secluded rear garden features a large patio area, perfect for alfresco dining, alongside a well-maintained lawn, creating a tranquil outdoor oasis. The paved driveway leads to the garage and offers off-road parking for several vehicles, enhancing the practicality of this delightful home.

This bungalow on Woodland Avenue is a rare find, combining spacious living with a prime location, making it an ideal choice for those seeking a peaceful yet connected lifestyle in Windsor.

**General Information**

Tenure: Freehold  
Council Tax Banding: G

**Legal Note**

\*\*\*Although these particulars are thought to be materially correct their accuracy cannot be guaranteed and they do not form part of any contract\*\*\*









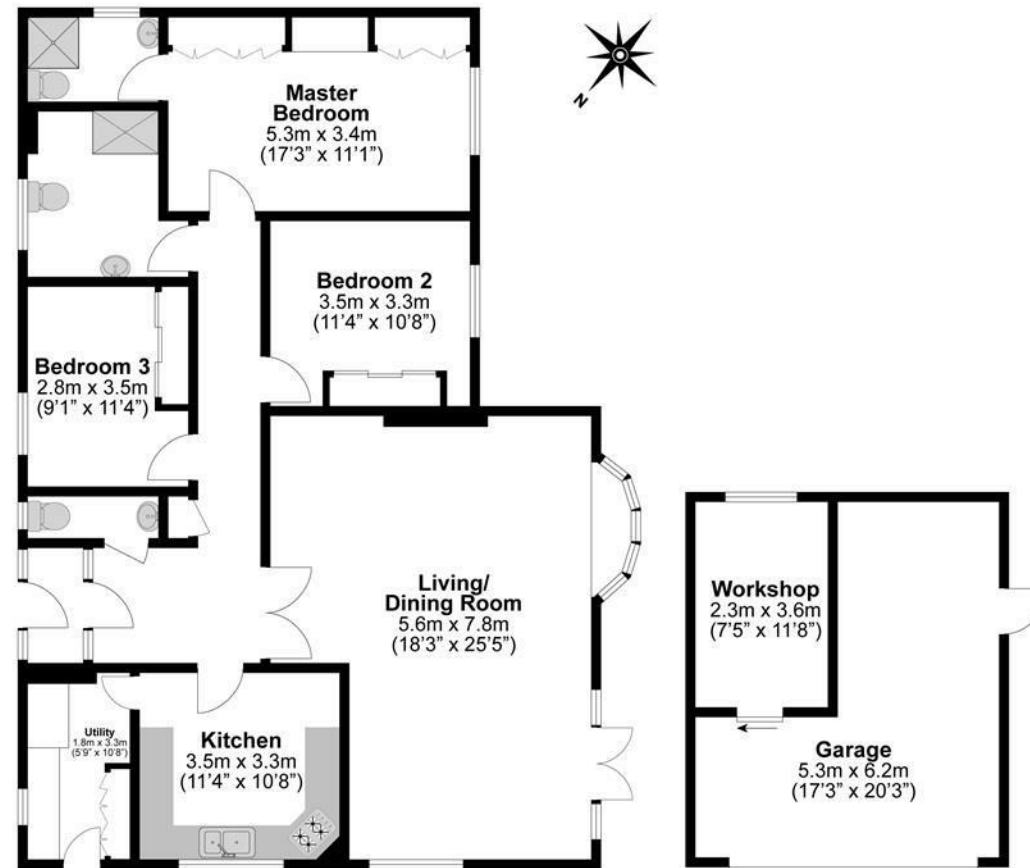

**Illustrations are for identification purposes only,  
measurements are approximate, not to scale.**